

Light ARCHITECTURE



▶ A very “cosy”
reading room



▶ An awning
in tropical shades



▶ A chameleon
in its own environment

Our watchword, passion and main objective is to act as a “merchant” of light

to give free rein to the imagination and creative spirit of artists, designers and architects. Day after day, our construction systems are enriched with new layouts, colours and forms to stimulate endless inventiveness... Pride of place this issue goes to the unusual and surprising use of Danpalon which plays on a wholly different register than mere transparency (see page 11). We also seek to build connections: connections between the old and the new, stationary and movement, natural and artificial... and facilitate architectural projects through technological innovation and cutting-edge technical assistance. In tropical climes, an azure-blue awning has been installed using our strong and durable products that are approved for use in extreme weather conditions (page 5). Each project featured in this issue sheds light on the different aspects of our business and the partnerships we maintain with all players in the construction sector, with one key mission in mind : to act as a “merchant” of light.

alain chambon

A very “cosy” reading room



The reading room at the Val-de-Reuil media library is a real beacon in the town, welcoming users into a calm, protective environment, thanks to the skilful use of Danpalon.

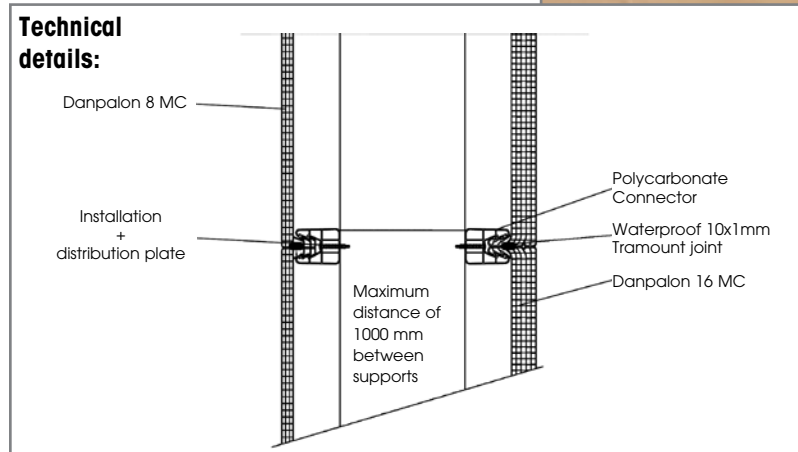

The media library in the town of Val-De-Reuil in Normandy tended to go un-noticed since it was completely submerged within the surrounding housing estate. To remedy this situation, the local authority launched a competition in 2002 for projects to renovate and refurbish the library entrance. “Finally, we opted for a total renovation”, explains **Jean-Baptiste Piétri**, the architect behind the winning project, “working in close collaboration with the head librarian.”

The entrance was moved to a more central position, at the corner of the main street and the square. A Danpalon “box” was set into the façade to create the reading room which now stands out above the porch. “We wanted to use a material that could not be broken. As the south façade is illuminated, using translucent Danpalon meant that we could keep the library’s intimate atmosphere without losing any of its crucial lighting”, adds **Jean-Baptiste Piétri**.

“We used Danpalon on both sides of a metallic structure. With its horizontal strips, it is easier to work with and the glass can be cut more easily. It seemed the natural choice for the project and the contractor is delighted with the result.”

Cosy and welcoming inside, the reading room is equally impressive when viewed from outside. Indeed, it seems to stand as a sort of beacon and acts as a landmark in the town when the street lights come on. At the same time, readers feel protected in a calm and studious atmosphere. The media library is a resounding success. Since the completion of its renovation last year, the number of users has risen by over 40% !



A Unifying Project

Danpalon is the ideal material to enhance architectural design and create a subtle and harmonious atmosphere bringing together three distinct working environments.

Seen from a distance, the Groupement Pharmaceutique Guadeloupéen is a parallelepiped standing 12 metres high and 200 metres in length. This structure houses the company's head office, bonded warehouses, a processing zone for sorting medicines and rented offices. **Pile & Face, the architect**, wanted to give the building a more unified and dynamic appearance in keeping with the forward-looking image that the Groupement Pharmaceutique Guadeloupéen has built up over the past 40 years. The result is a unifying and highly original design. Surrounded by two discreet wings, a superb central hall encased in a green, transparent Danpalon brings light flooding into the warehouse areas.

Company : Castel & Fromaget
Danpalon 16 MC - 1040 mm Green

Capitalising on this experience, EVERLITE CONCEPT commissioned the SOCOTEC company to draw up a list of particular technical specifications for the use of DANPALON components in the overseas territories in light of the extreme climatic conditions that prevail in these environments. Always one step ahead in the field of technical certifications, EVERLITE CONCEPT is today the only company able to offer these DOM/TOM specifications which constitute the essential tool for service providers and regulatory bodies. Indeed, these specifications certify that the DANPALON range can be used safely as a casing or shell on buildings in France's overseas departments and territories.

THE CHOICE OF UNIQUE TECHNICAL RELIABILITY

Everlite Concept SA has been working for several years with France's overseas departments and territories (DOM/TOM) where extreme climatic conditions push building procedures to their absolute limits. In 2002, under the control of the French government's experimental ATEX regulations, it installed a Danpalon awning at Pointe-A-Pitre airport in Guadeloupe. Following approval by the CSTB (the government scientific and technical construction centre), the DANPALON components were installed in accordance with the latest safety regulations.



An awning in tropical shades

In the tropics, you need to be protected not just from the sun but also from rain... Since winds can reach up to 40 to 50 km per hour and rain fall at angles of 45°, roof eaves have to be very wide. Moreover, the easterly trade winds blow constantly in the same direction. This explains why awnings on buildings lean more to the west to provide protection against the setting sun and rain. Naturally, all parameters concerning earthquakes and cyclonic winds were taken into account when making the necessary calculations to adapt the material for a tropical climate. As **Alain Nicolas** explains, "The most important elements are the bindings. Fixing the Danpalon was the most sensitive part of the project and Everlite's technical team has extensive experience in this field."

Company : Karukera Metal BAT
Danpalon T6 MC - 600 mm Green



The renovation of the Lauricisque cultural centre aimed to provide a safer, more dynamic community venue in the heart of a residential district of Pointe-à-Pitre.

The Lauricisque cultural and community centre was ill served by its old sheet metal roof which was neither attractive nor particularly effective in keeping out the rain. Now, during the interval in a performance, the audience can wander freely on a new deck bathed in turquoise light and enjoy a completely new atmosphere. The project was commissioned by the Pointe-à-Pitre local authority to improve access and make this centre of dialogue and artistic expression a more attractive venue for both performers and visitors. The deck is a raised floor that encircles the performance hall and is used as a walkway underneath its protective canopy. "We wanted to keep the idea of a large awning but bring in more light", explains **Alain Nicolas**, the project architect. "We chose Danpalon for this three-dimensional canopy covering 400m² since it has great luminosity and interesting thermal qualities. The turquoise shade is a personal choice as it's my favourite colour at Everlite – and the colour of our islands !"

A life-sized showroom !



When a building suppliers wants to highlight its environmentally-friendly products, it displays them within the Danpatherm - a building which is itself a showcase of innovative solutions which has become the image of the brand !



Company : Genty S.A.
Danpatherm : Danpalon 10 MC - 600 mm Crystal

The architect, contractor and building supplies merchant, know each other well. They have worked together for 15 years and constructed two buildings. For their third and quite different project – a new building at Liévin, in northern France – their mutual cooperation was seen to its full advantage. Their remit was to combine the warehouse, offices and the showroom in the same building to present innovative building supplies that help to protect the environment and foster sustainable development. "I quickly understood that this building had to embody this theme and act as a vector for business. We had to highlight originality and create a sort of huge model using the very innovative materials we wanted to promote. The Danpatherm is 100% recyclable, saves energy and thus falls perfectly within our criteria", states architect **Frédéric Kurzawa**. At first, the contractor was unsure about the choice of the Danpatherm, "but with photos and samples he saw that we were planning to use a quality and highly-creative product", he adds. The 8-metre high façade is quite thick because of the Danpatherm's double-sided design. This presents a host of advantages in terms of insulation and safety. For example, if a section is damaged, the second thickness serves as a protective layer while repairs are carried out. Another advantage is the night lighting which literally transforms the structure. The brand name has been screen printed on a micro-perforated adhesive film and stretched across 25 metres of the façade. When the building is lit, it becomes an important vector of communication for the brand.

Close-up on lighting designers

What exactly do they do ? Lighting designers design and develop the lighting elements and features in an architectural project. "We are service providers in the same vein as architects and landscape gardeners. We design projects for the different uses of light and define the technical aspects and solutions", explains Anne Bureau, President of ACE* (the French association of lighting designers). Founded in 1995, this young organisation now has over 80 members and works actively to promote the work of designers who work with lighting.

Lighting designers are involved at the earliest stages of a project and join the team as consultants and experts when contractors are forming their bids. "The earlier lighting design is integrated into a project, then the easier it is for all those involved

since we can discuss with the architect about the best orientation for a building and the choice of materials", continues Anne Bureau. "We have a specific lighting "eye" and thus bring an added dimension to all projects."

Lighting designers work with the effects of light sources and installations – both natural and artificial – transform them and make them magical. "Polycarbonates, like Everlite/Dan Pal (UK) materials, are highly creative light-transmitting elements. They give a new consistency to light such as the incredible night-time atmosphere they create for contemporary buildings", she concludes.

* ACE : Association des Concepteurs lumière et Eclairagistes

A 19th-century glass roof



The glass roof at the Haute Follis high school in Laval has found all its lustre of yesteryear as part of the complete renovation project at the lycée.

Danpalite is a material of the future that can be used harmoniously with the architecture of the past. This is seen to good effect with this beautiful 19th-century glass roof very much in the style of winter gardens and orangeries that were built in the grounds of châteaux and stately homes of the period. When the OGEC (the Catholic school management board) of the Haute Follis high school in Laval, France launched the general renovation project, the restoration of the glass roof was at the heart of the programme. "The school's reception area was repositioned in relation to the glass roof. Therefore we had to completely replace the glazing and renovate the structure to recreate its 19th-century aspects", explains architect **Yves-Marie Belaud**. "The glass was replaced with a material that could be curved while retaining the full transparency required by the contractor. These constraints led us to choose Danpalite Crystal from the Everlite/Dan Pal range." The technical specifications were drawn up in collaboration with Everlite's technical department. The installation was carried out by the Guyon & Sons company while the architects modified the roof's metal frame to support the new material. "I know Everlite's building systems well. Seven years ago, we designed a modern-style glass roof for the social security offices in Laval. It was a curved roof with a built-in sunshade. We never had the slightest problem with the project", concludes the architect.



Company : SARL Guyon & Sons - Danpalite Crystal

A chameleon in its own environment...

With Danpalon, the Carrefour shopping centre at Saint-Egrève, near Grenoble, melds totally into the beautiful mountain landscape !

Shoppers are pleasantly surprised when they see how the new-look facade blends into the surrounding environment. The main wall of the shopping centre features a 225° panoramic photo with the outlines of the nearby Cluze de Voreppe mountains. The sky can be made out in the background and it brings changing colours and shades to the facade depending on the time of day. Because of these transformations, the shopping centre was named "Caméléon" when it was re-opened in September 2006.

"The programme included the re-design of the façade and the entrances, as well as the extension of the shopping areas", explain **Jean-Marc Pivot** and **Kim Kilzi from Sud-Architectes**. The aim of the project was threefold: the Carrefour-Hyparbo group, the contractor, wanted to renovate the shopping centre, communicate with customers around its new brand image and help the local authority to pursue its mission to create a more environmentally-friendly atmosphere in the town's outlying districts."



Company : Etancoba - Danpalon 16 MC - 1040 mm Crystal

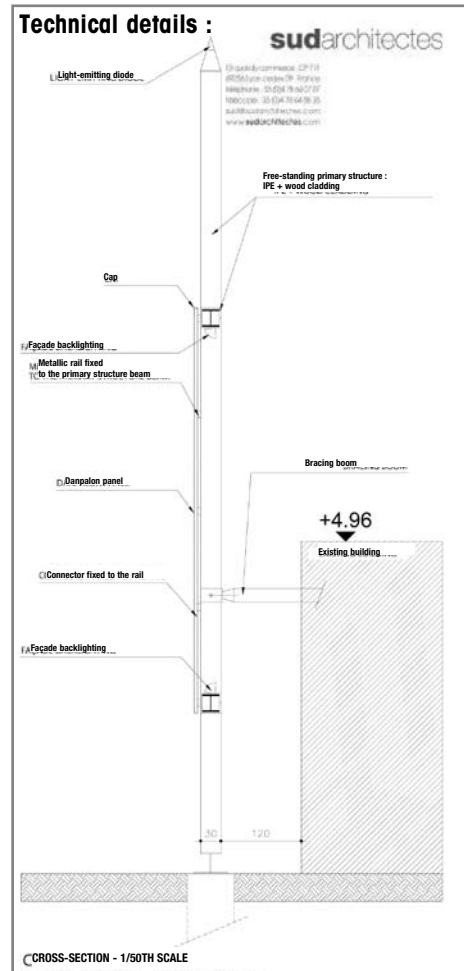

The architects decided to keep the original facade and cover it with a separate Danpalon skin which acts as a screen to hide the previous structure and masks differences in the original levels and dimensions of the facade. The Etancoba Company installed the Danpalon panels on a metallic frame. They were then fixed to a series of wood-clad metallic posts set in a concrete base. Finally, the environmental and sustainable development-theme graphic was created in the form of successive 3M films.

"We wanted a translucent material that would diffuse both natural and artificial light. We found it with Danpalon, which is the ideal medium for creative designs : it is airtight and its cells do not collect dirt or yellow with age", explains **Kim Kilzi**. Also, as it is 100% recyclable, it is perfectly in keeping with the ecological aspects of the project which uses natural materials and locally-grown timber such as larch.

At night, the centre takes on a wholly different aspect. The lighting is kept soft for ecological and aesthetic reasons. The façade is lit by means of back-lighting through the Danpalon while at regular intervals small blue diodes act as beacons at the top of each masthead. To complete the effect, the three illuminated customer entrance bays act as an enticing invitation to draw customers inside.

Both day and night, the Saint-Egrève shopping centre melds perfectly into its surrounding environment.

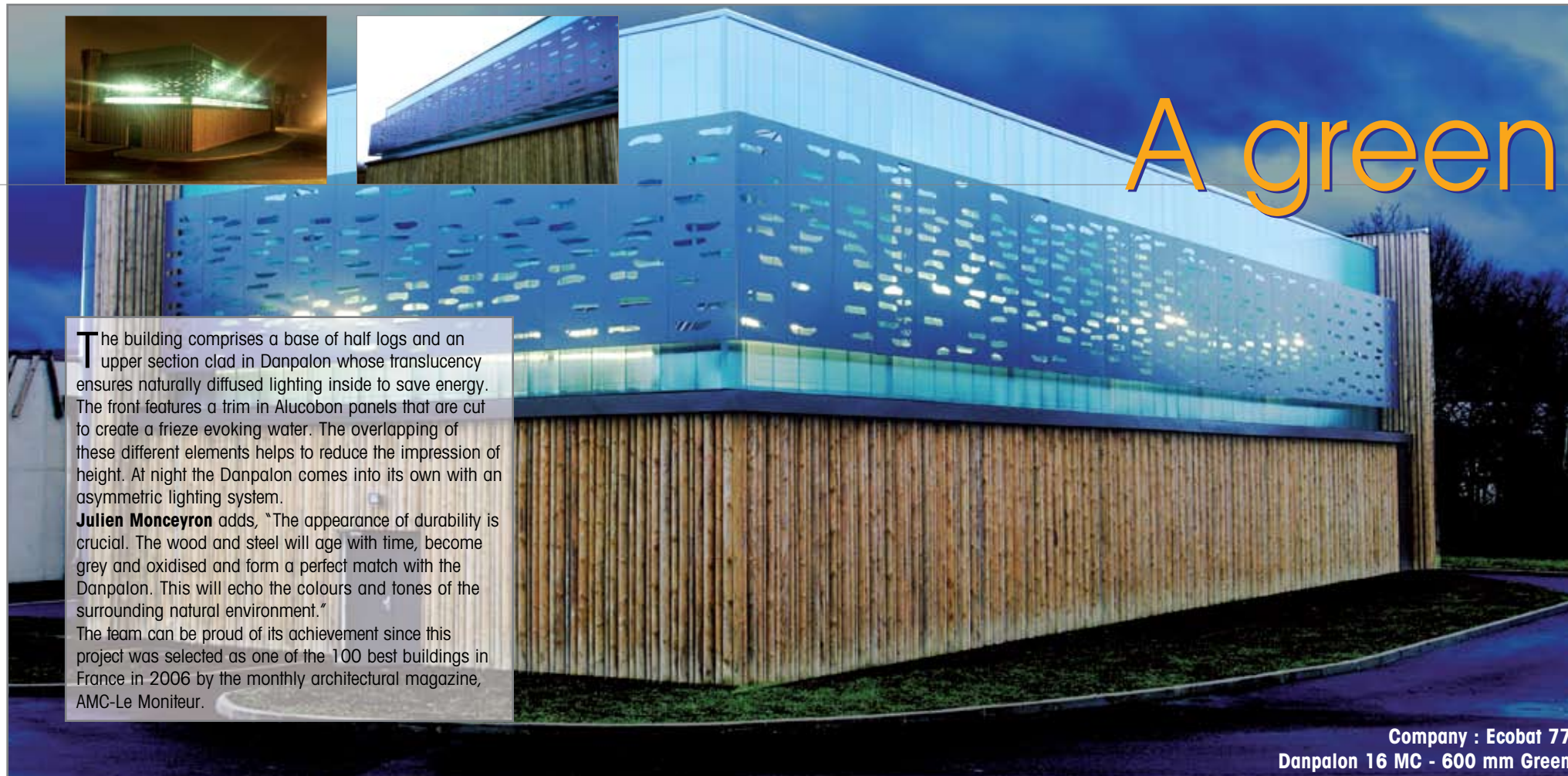

A green staging



The architectural design of the water processing facility at Boissise-la-Bertrand in the Ile-de-France region is in keeping with the plant's purpose. Mission accomplished thanks to the use of Danpalon with wood and steel.

For the contractor - the local authority of the town of Melun, the concession holder - Véolia Eau, and **Cabinet Monceyron – the architects**, the construction of the water processing plant was clearly a High Environmental Quality procedure to ensure that the completed structure blended perfectly into the leafy environment at Boissise-La-Bertrand. It was, therefore, only natural to use wood and recyclable materials such as steel and Danpalon. "We positioned the buildings behind a wide stretch of woodland that is protected by the National Forestry Office. The facades are more or less ornate depending on their position. The three materials were used on the water processing plant", explains **Jean-Pierre Monceyron**. "Danpalon is a fascinating medium as it can be used almost anywhere to create original and highly contemporary contrasts."

The building comprises a base of half logs and an upper section clad in Danpalon whose translucency ensures naturally diffused lighting inside to save energy. The front features a trim in Alucobon panels that are cut to create a frieze evoking water. The overlapping of these different elements helps to reduce the impression of height. At night the Danpalon comes into its own with an asymmetric lighting system.

Julien Monceyron adds, "The appearance of durability is crucial. The wood and steel will age with time, become grey and oxidised and form a perfect match with the Danpalon. This will echo the colours and tones of the surrounding natural environment."

The team can be proud of its achievement since this project was selected as one of the 100 best buildings in France in 2006 by the monthly architectural magazine, AMC-Le Moniteur.

Company : Ecobat 77
Danpalon 16 MC - 600 mm Green

Like a game of building blocks....

Danpalon gives free rein to creativity as can be seen with the school canteen of Les Prés Hauts in the town of Saint-Germain-lès-Corbeil, near Paris, where architects have transformed it from its utilitarian aspect !

The new school canteen at Les Prés Hauts in Saint-Germain-lès-Corbeil had to be built within the existing building dating from the 1970s-80s. The firm of **Monceyron Architectes** wanted to give the extension a unique visual identity. Like a new piece in a game of building blocks, it now forms a link between the nursery section and the primary school. At lunchtime, the canteen lights its beacon to let children know it's time to eat. But this is not the only original feature of the project. The other breakthrough is the unconventional use of Danpalon. For a change, it is not intended to play with the effects of natural light or to act as a translucent source of light. Instead, it is used as a membrane to cover two opaque architectural elements which house the school's technical premises...

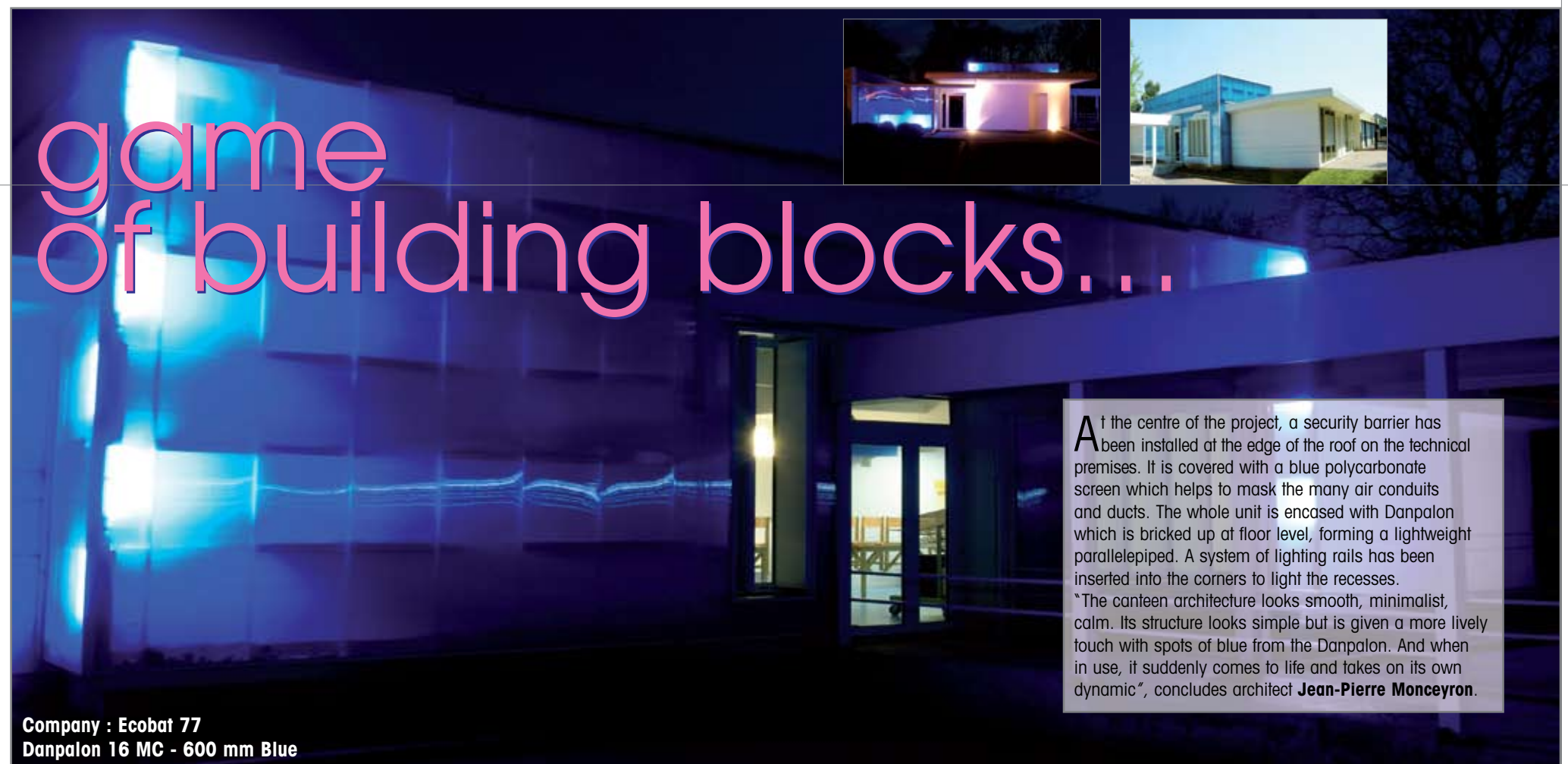

At the centre of the project, a security barrier has been installed at the edge of the roof on the technical premises. It is covered with a blue polycarbonate screen which helps to mask the many air conduits and ducts. The whole unit is encased with Danpalon which is bricked up at floor level, forming a lightweight parallelepiped. A system of lighting rails has been inserted into the corners to light the recesses.

"The canteen architecture looks smooth, minimalist, calm. Its structure looks simple but is given a more lively touch with spots of blue from the Danpalon. And when in use, it suddenly comes to life and takes on its own dynamic", concludes architect **Jean-Pierre Monceyron**.

Company : Ecobat 77
Danpalon 16 MC - 600 mm Blue

United Kingdom : Nurturing originality

This small corner of paradise caused a sensation at last year's Chelsea Flower Show. Starting from a simple wooden structure, with structural bamboo supports, designers at **Proctor and Matthews Architects** came up with the brilliant idea of covering it in Danpalon Green to create a feeling of being under the canopies of the Congo rainforest, where much of the inspiration is derived. It is not just a stand; it is a work of art set in a haven of plants and flowers where it truly stole the show !

Although this composition is wholly charming, it leaves an impression of not going far enough. Indeed, it was only a foretaste of things as the prototype for a newly opened visitor area at London Zoo where the same material is being used, but on a much larger scale for the Gorilla Kingdom... to be continued.

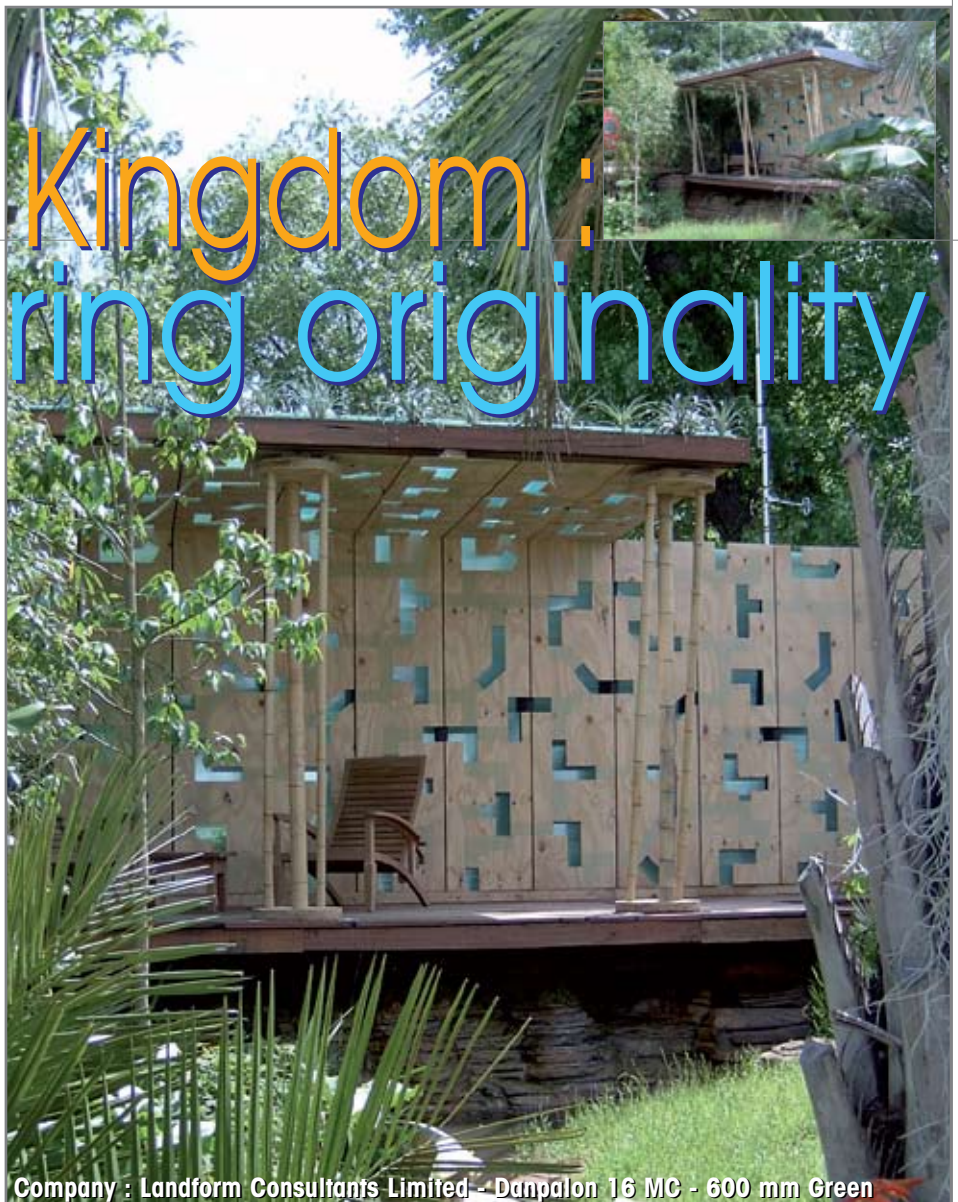

Company : Landform Consultants Limited -- Danpalon 16 MC - 600 mm Green

THE FRENCH NATIONAL TESTING LAB : PARTNER FOR EUROPEAN CERTIFICATION

Since the 16th February, Danpalon has been officially recognised by the Euroclasses certifications for its fire resistant qualities. It has been awarded the B - s2, d0 rating for the excellent performance obtained in the strict testing protocol at the French National Testing Laboratory (LNE).

The LNE plays an important role in harmonising standards resulting from the introduction of the European regulatory certification programme (CE labels). Consequently, Everlite has decided to work with this internationally-recognised body to pursue its long-standing strategy to ensure that its products are installed and used in the best possible conditions.

The housing/construction sector is one of the many fields covered by the activity of the LNE. With specific testing protocols such as the SBI (Single Burning Item) it checks that materials meet essential requirements in terms of fire resistance in respect of the Building Products Directive.

To continue to offer its customers the maximum guarantees in terms of fire safety, Everlite places its full trust in the LNE for the testing procedures and the quality of the information and assistance it provides for companies for the certification of their products.

Dan Pal Kibbutz Dan, 12245, Israel,
Tel: +972-4-6953811/6, Fax: +972-4-6958105
E-mail: danpal@danpalon.co.il , Website: www.danpalon.com

